



Install Attention Point:

- 1、Please keep your hand clean and dry when you install our product.
- 2、Please use correct and excellent tool to strip off the optical cable or the surface coating .
- 3、Please process the length control device or tool path groove in correct way when you cut off the optical cable.
- 4、Please choose excellent cutting tool to reduce the damage of the optical fiber.
- 5、Please keep the cutted dumped optical fiber in safe way to avoid the damage of the people.
- 6、Please note the process way and strength when you embed the optical fiber into the connector in order to avoid the break of the optical fiber.
- 7、Please make the optical fiber in tiny curve before lock the locker.
- 8、Please avoid the dust into the connector when you process the installing,the dust will affect the communication data.

The using installation guide

LC/UPC-H06
LC/APC-H06

Embedded Quick Assembly Connector



*Before installation, please read carefully the installation guide

The using installation guide

Model LC Connector

Embedded Quick Assembly Connector



1. The components of the connector.



2. Across the optical cable into the end cap.



3. Use correct tool to strip off the optical cable scarf skin.



4. Put the cable into the length control device, use tool to strip off the surface coating.



5. Use specialized clean wiping cloth clean the optical fiber.



6. Cut the optical fiber.



7. Move the locker to the bottom.



8. Across the optical fiber into the connector from the tail part to the limiting stop position,make sure the optical fiber in tiny cruve state.

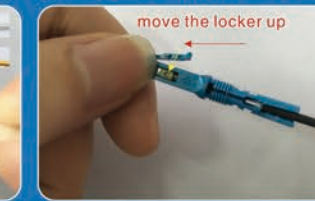

9. Keep the optical fiber connected and move the locker up to lock tightly.



10. Move up the end cap, twine the kevlar strings on the end of the connector and screw the end cap tightly.

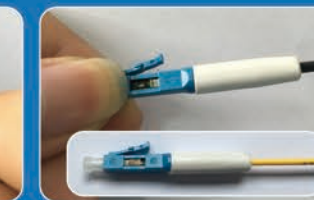

11. Finish the assembling.

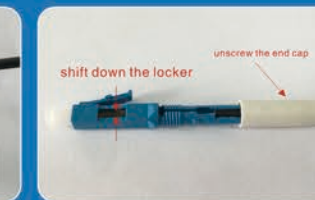

12. Repeat using,shift down the locker to loose the optical fiber,unscrew the end cap to loose the optical cable to re-assemble.

